

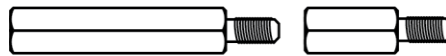

Outdoor Housing Compatibility

- **D2/D3:** Internal Lens + Bottom Mounting + 2.0 in. Standoffs
 - Standoff Combination: **1 ½" + ½"**



Camera Specifications (mm)

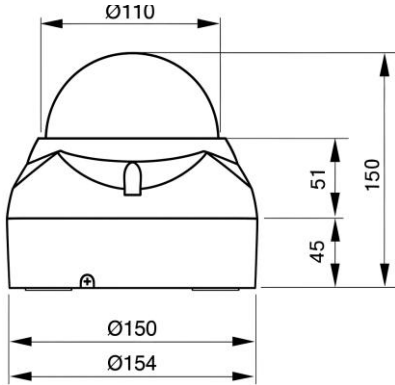

Power Input	PoE, 12VDC, 24VAC
Maximum Power Consumption	12 W
Operating Temperatures	-10°C to +45°C
Weight	1.6 kg
Dimensions (L x W x H)	154 x 154 x 150 (mm)

Housings Drawings (in.)

