

## QUICK GUIDE

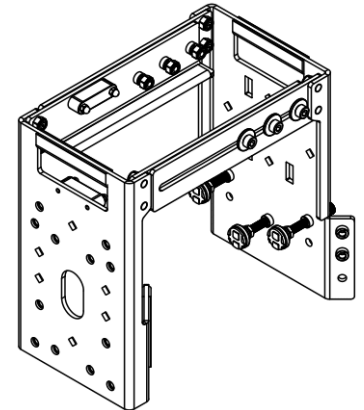

### Z-BRACKET UNIVERSAL ROOF MOUNT

ZB080QG (5/25)



This Quick Guide provides a visual summary of the installation process. For full assembly instructions and safety guidance, visit: [www.dotworkz.com/z-bracket](http://www.dotworkz.com/z-bracket)



#### Package contents

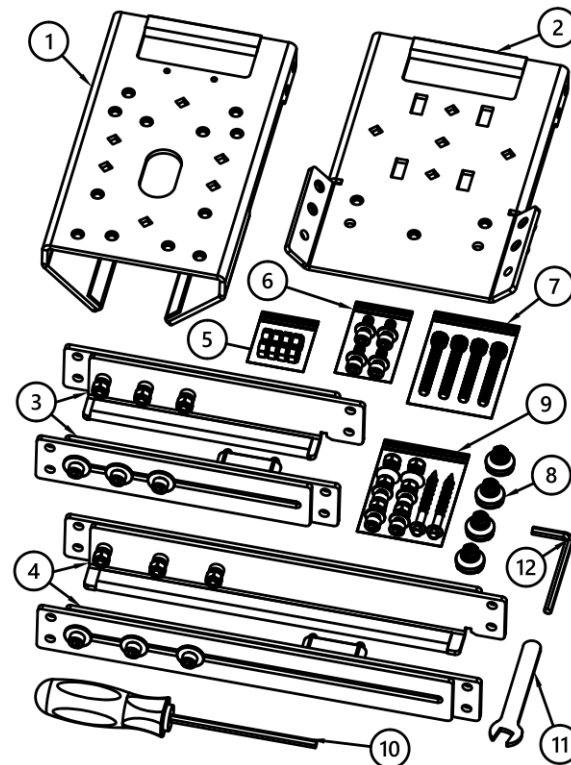

1. Front plate
2. Back plate
3. Small arms set
4. Large arms set
5. Arms set locknuts
6. Camera mounting hardware
7. Swivel mount screws
8. Swivel mounts
9. Additional hardware pack
10. Hex screwdriver
11. Open-end wrench
12. Hex L-Key

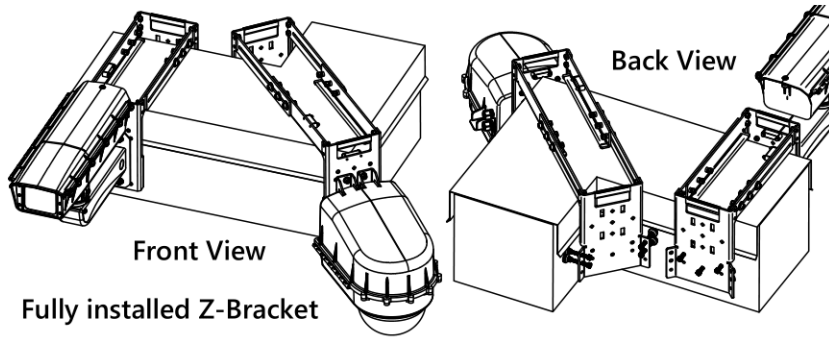

#### General guidelines

- Verify the rubber pieces are fully pressed into place.
- Properly lock the swivel mount assemblies by holding the mount with a wrench while driving the screw fully.
- Do not loosen the sliding arms before unfastening the swivel mounts during uninstall.
- Do not overtighten swivel mount screws, excessive torque is unnecessary.
- For wall installations with flashing, pre-extend the swivel mounts slightly so they make direct contact with the wall, not the flashing.

#### Best practices

- Install camera equipment before placing the bracket on the wall.
- Keep a hand on the front handle when the arms are loose.
- For wall installations with flashing, pre-extend the swivel mounts slightly so they make direct contact with the wall, not the flashing.
- If using a permanent install, mark and pre-drill your anchor holes before closing the bracket.
- Check all levels before final tightening. Make sure the mount is sitting level before securing the swivel mounts completely.
- Always follow all applicable local building codes, safety regulations, and OSHA standards.

Need help? Visit: [www.dotworkz.com/z-bracket](http://www.dotworkz.com/z-bracket)

Full manual, videos, and warranty information available online.

© 1998 - 2025 Dotworkz - All rights reserved



## ASSEMBLY

Identify the required configuration using the chart below, based on your wall type and desired mounting position.

	Wall Thickness (Inches)			Swivel Mounts
Straight	<b>5.5" → 11"</b>	<b>11" → 20.5"</b>	<b>20.5" → 34.5"</b>	<b>3 Mounts</b>
	Small Arms	Large Arms	XL (Both Arms)	Flat Face
Corner	<b>2" → 6"</b>	<b>5.5" → 13"</b>	<b>12.5" → 24"</b>	<b>4 Mounts</b>
	Small Arms	Large Arms	XL (Both Arms)	'Wing' Bends

① For XL setups, connect both arm sets using M8 screws (20mm), washers, and locknuts from the additional hardware pack.

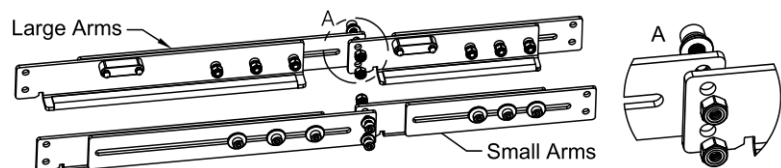

① Attach the sliding arms set to the front and back plates using the provided M8 locknuts. Tighten securely to hold the assembly in place.

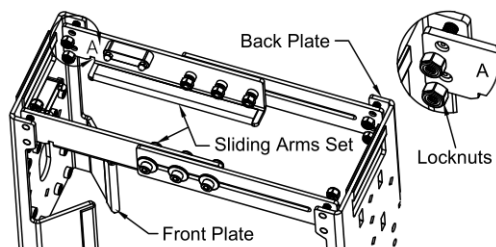

② Mount the swivel mounts to the back plate using the included M8 screws (60mm).

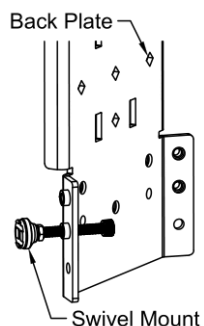

③ Mount your camera or housing using the matching hole pattern on the front plate and the mounting hardware.

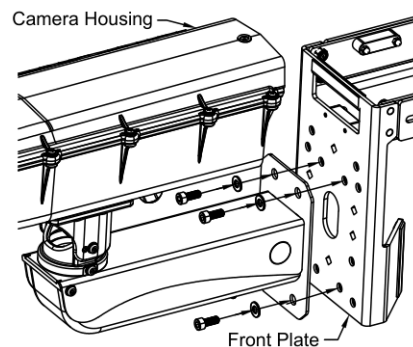

## INSTALLATION

④ Set the Z-Bracket onto the wall so it rests flat with the front arms fully supported.

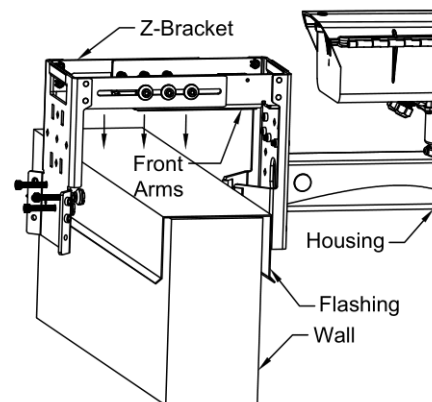

⑤ Slide the back plate forward to close the Z-Bracket until the swivel mounts contact the wall.

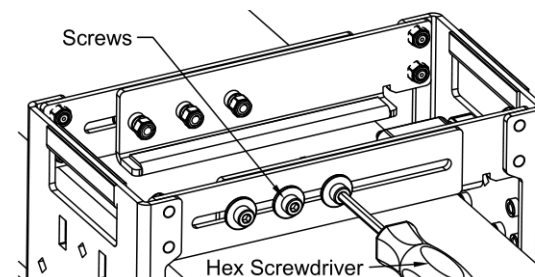
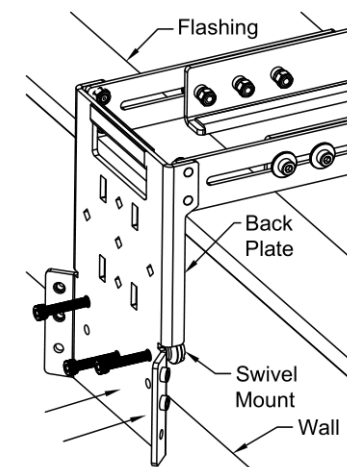

⑥ Tighten the screws on the sliding arms to lock the bracket in position.

⑦ Drive the swivel mount screws into the wall, tightening the top screws evenly in alternating turns. Finish by driving the bottom screw(s) just until they make firm contact (not fully pressured).

