

Outdoor Housing Compatibility

- **D2 & D3:** External Lens + Bottom Mounting + 4.125 in. Standoffs

- Standoff Combination: $\frac{3}{8}" + 1 \frac{1}{2}" + 1 \frac{1}{2}" + \frac{3}{4}"$



- **HD12:** 4.25 in. Standoffs

- Standoff Combination: $1 \frac{1}{2}" + 1 \frac{1}{2}" + \frac{3}{4}" + \frac{1}{2}"$

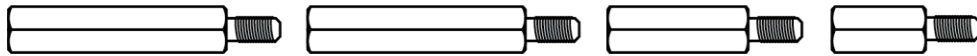

Camera Specifications (mm)

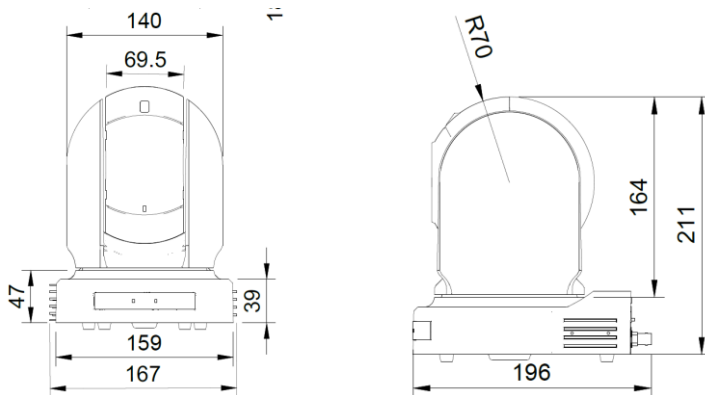

| | |
|----------------------------------|-----------------------------|
| Power Input | PoE+, 12VDC |
| Maximum Power Consumption | 19.7 W |
| Operating Temperatures | -10°C to +50°C |
| Weight | 2.0 kg |
| Dimensions (L x W x H) | 195 x 164 x 214 (mm) |

Housings Drawings (in.)

