



Architectural & Engineering Specifications (A & E)

Sealed Outdoor Camera Enclosure universally Compatible with most brand and models of IP and analog PTZ and Mini-Dome Camera.

PRODUCTS

1.00 MANUFACTURER

- A. Dotworkz, Inc.
9340 Stevens Rd
Santee, CA 92071
PH. +1 (866) 575-4689
Sales@dotworkz.com
- B. This product shall be manufactured in the USA using the highest quality.

1.02 GENERAL CAMERA ENCLOSURE DESCRIPTION

- A. Camera Enclosure specified shall be designed for Ethernet network cameras & CCTV cameras for commercial, industrial, or government applications requiring a rugged, sealed outdoor rated camera enclosure with compatibility to house a broad range of Pan Tilt Zoom (PTZ) or fixed Mini-dome cameras that are commercially available for IP, and High Definition, and CCTV capability.
- B. Camera Enclosure shall be minimal outdoor protection rating of **IP66** and/or NEMA 4X and shall include harsh environment IP68 or better cable seal strain relief connector ports.
- C. Customer supplies camera to be installed into the enclosure.

D2-CD-12V Actively Cooled Outdoor Housing

Dotworkz D2 COOLDOME Outdoor Enclosure for Surveillance Camera Systems

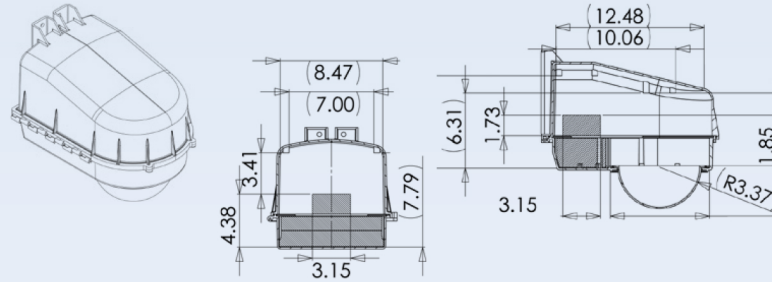

1.03 CAMERA ENCLOSURE REQUIREMENTS

- A. Shall provide power to compatible cameras @ 12 VDC, and environmental control board for providing power to protective elements which includes a thermostatically controlled active 400 BTU Active COOLER, & an integrated 40 CFM internal Fan.

1.04 ENCLOSURE MOUNTING REQUIREMENTS

- A. Shall have integrated capacity for wall mounting of enclosure
- B. Shall be compatible with optional brackets with capacity for strap mounting pole mounting of enclosure, corner mounting bracket options, and parapet mounting options, and non-penetrating roof mounting.
- C. Shall be compatible with a media connection cable of Category 5 and/or Category 5 Enhanced and/or Category 6 twisted pair (UTP) cable, or analog coaxial cable.

2.00 Electrical Specification

- A. Enclosure shall be powered by dedicated nominal 12 VDC.
- B. COOLDOME™ Kit shall include an external step down power supply, Universal Input of 95-264 VAC (Single PH.).
- C. Shall have integrated a high flow 40 CFM blower fan.
- D. Shall have integrated thermostatically controlled 400 BTU (Q = 120 watts thermal) Active Solid State Cooler.
- E. Shall have integrated power to Camera of 12 VDC up to 40 watts, with user accessible camera power hook-up.
- F. Shall include one camera powering cable for quick camera powering hook-up.
- G. Shall have integrated safety fusing on All Camera Power outputs.
- H. Shall have integrated safety fusing on All Integrated Coolers & Blower fans.
- I. Housing Interior shall be fully insulated with dual layer foil & foam insulation providing optimal thermal protection against IR, UV, and conductive thermal transmission.

2.01 Mechanical Specifications - Housings

- A. Weight: **7.5 lbs.** (3.4 kg)
- B. Exterior 14.9(L) x 13.4(H) x 11.7”(W)
- C. Interior: 8.6(dia @ mount base) x 9.3 tall(6.8 dia. max @ lens) (Maximum camera size)
- D. Hinged Lower with Captive Stainless Steel Fasteners.
- E. Rugged Polycarbonate Housing (0.160” wall).
- F. Clear Acrylic Viewing Lens bubble 6.8” dia. x 3.7” deep.
- G. White Semi-gloss finish to PC housing.
- H. **Protective Urethane foam Gasket Seals.**
- I. Integrated wall mounting tabs.
- J. Integrated Omni Antennae mounting tab on side.
- K. Certifications: NEMA 4X / IP68.

2.02 Environmental Specifications

- A. **Operating Temperature Range: -20°F to 160°F (-29°C to 71°C)**
- B. Humidity: 10% to 90% non-condensing.
- C. Housing Shall meet or exceed a rating of NEMA 4X and/or **IP66.**
- D. Shall have two cable entry ports rated to **IP67** for power & data cables.
- E. Shall be deployable into a wide range hot environments of Residential, Commercial, Industrial, Marine, Desert, and other indoor & outdoor installations.